

# SUMMIT TELECOM

©2013 SUMMIT TELECOM ALL RIGHTS RESERVED

Web: [www.summittelecomm.com](http://www.summittelecomm.com)

E-mail: [sales@summittelecomm.com](mailto:sales@summittelecomm.com)

[summittelecomm@hotmail.com](mailto:summittelecomm@hotmail.com)



**FTTH Fast Connector and Mechanical Splicer**

**Item Code: STFC-SC**

## Installation Manual for Fast Connector



- **Structure:**

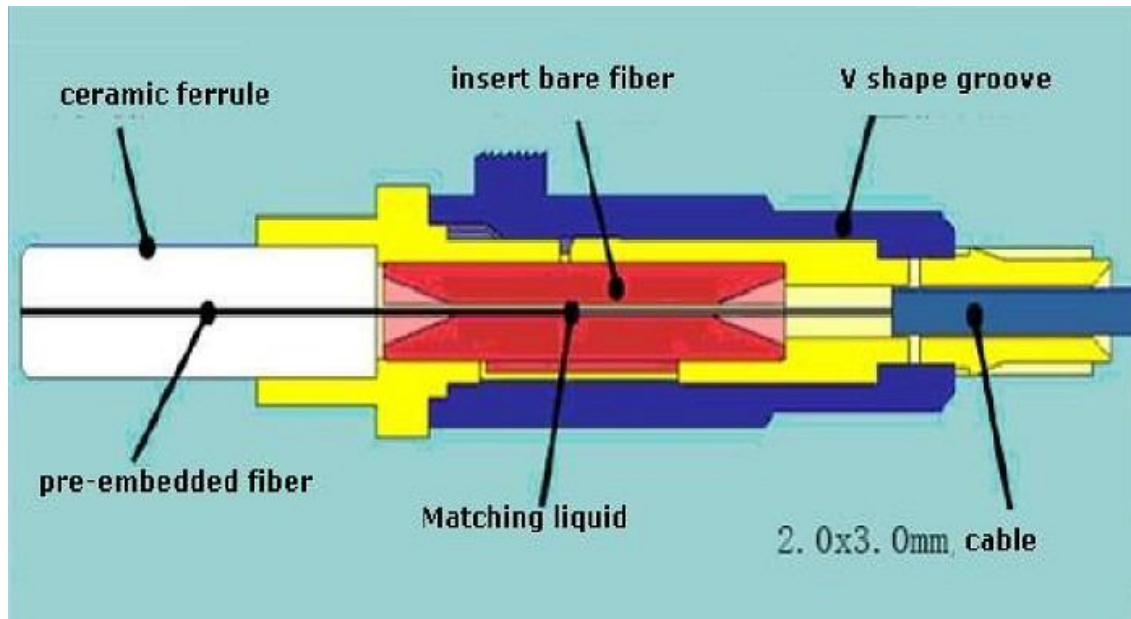

● **Necessary Tools:**

- 1, jacket removing tool    2, fiber coat stripper    3, fiber length measurement
- 4, fiber cleaver            5, a bottle of alcohol    6, cleaning tissue



● **Installation Steps:**

1,put on boot



2,fix the cable to length 35mm and strip the jacket

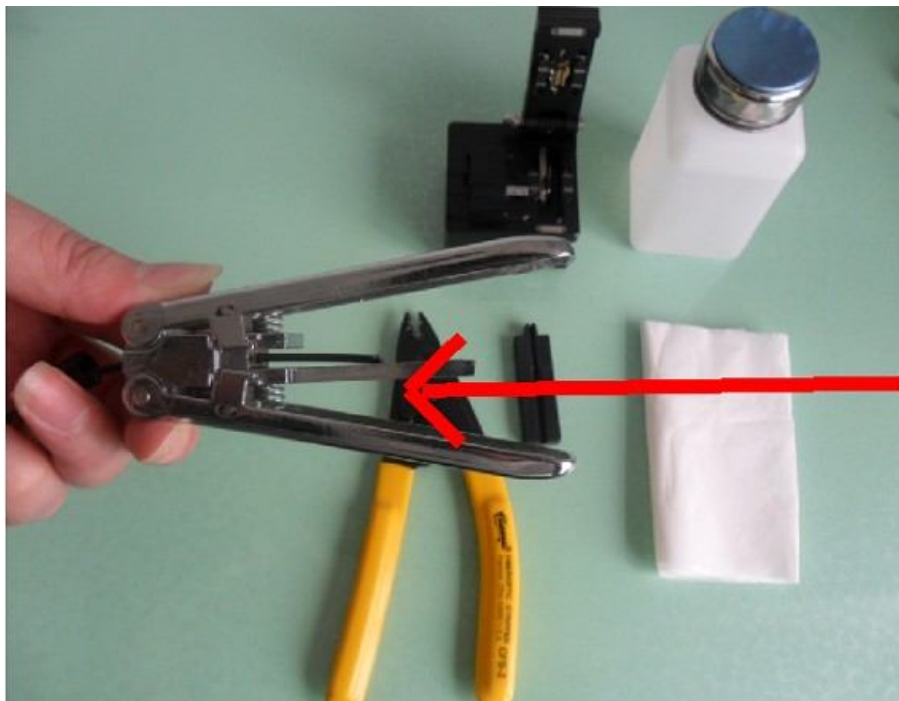

3,use jacket removing tool to remove the jacket



4,check the 250U fiber if it is damaged.flick the fiber with your finger to check if it is complete.



5,use coat stripper to strip the coat 25mm,use cleaning tissue and alcohol to clean the bare fiber.250U fiber length should be 40mm.

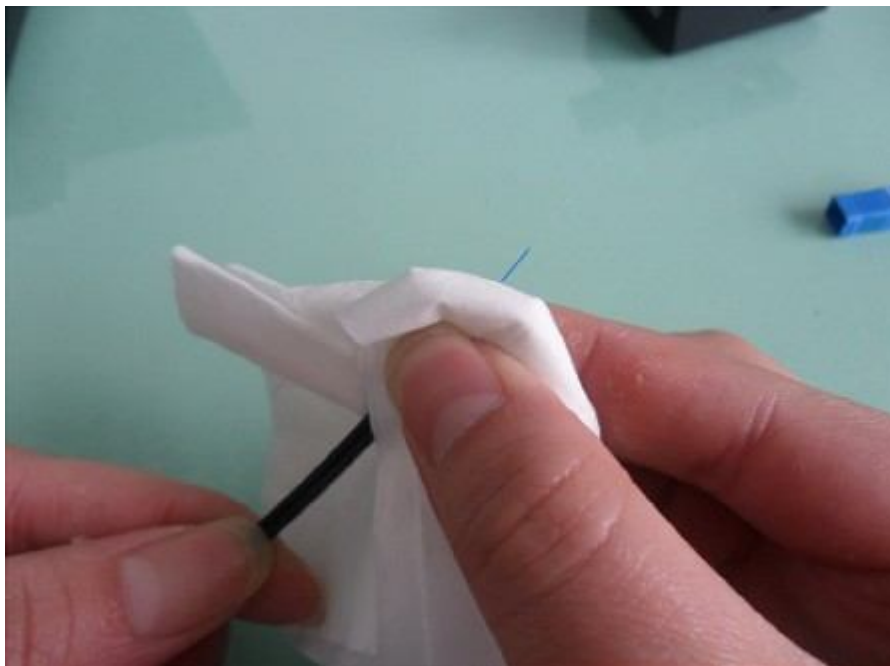

6,fix the bare fiber and use cleaver to cut the bare fiber(take care if the fiber end can be cutted).



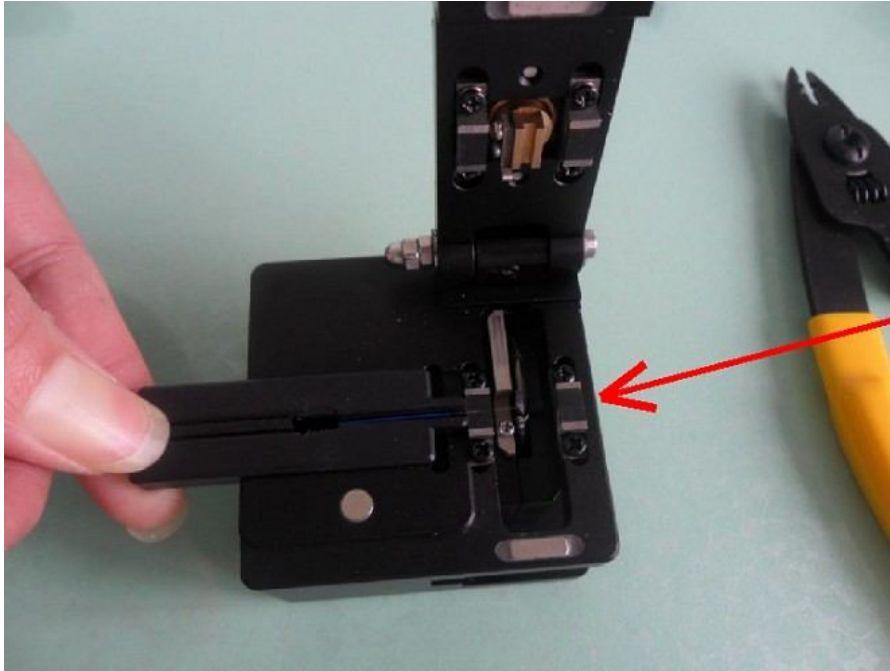

7, clean the fiber again after cutting.



8, insert the fiber to the fast connector.

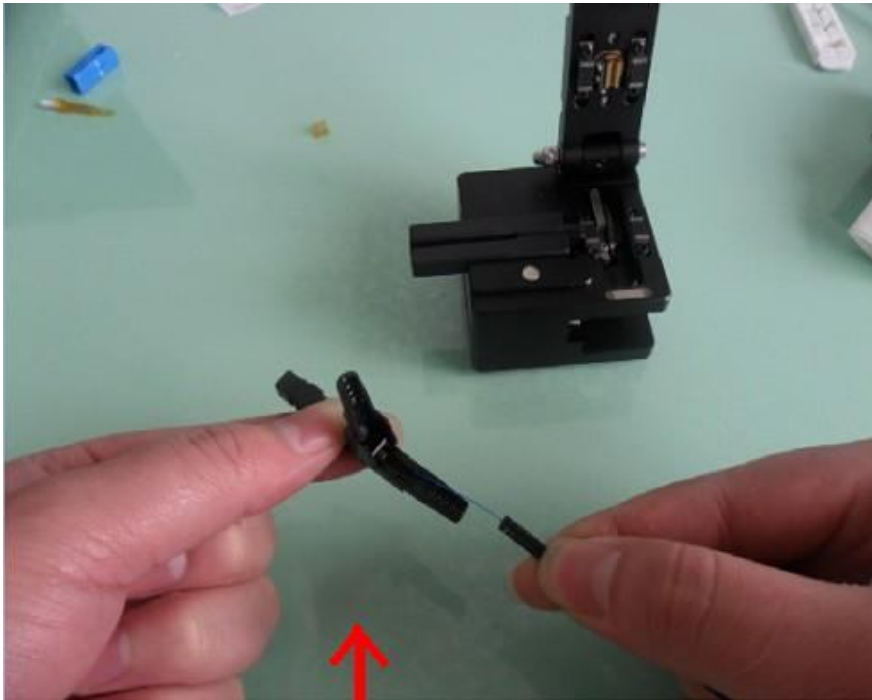

Insert the fiber to the top of the pre-embedded fiber,the fiber will be bending if



reach the pre-embedded fiber in the V shape groove,the connect well.

9,fix and lock the fiber in the right position.

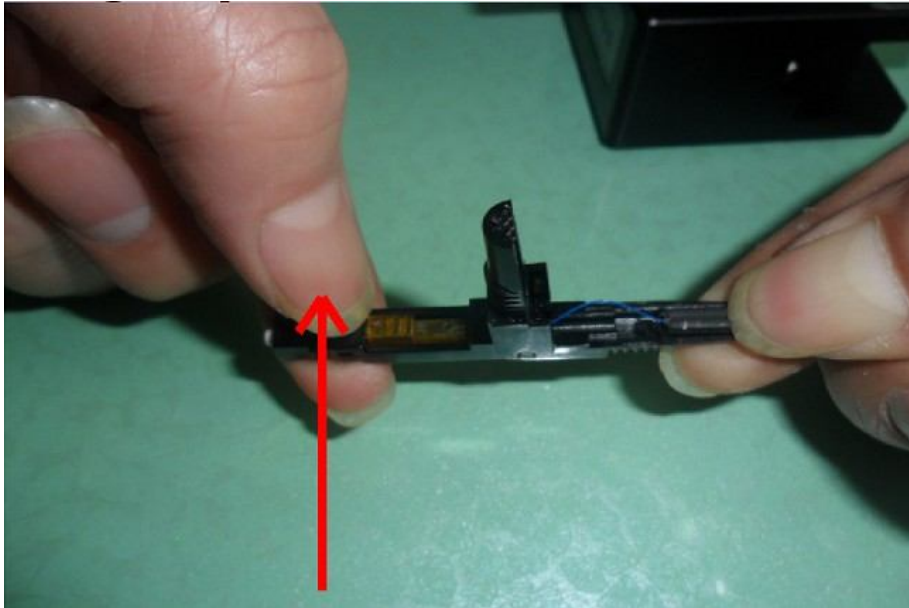

Keep fiber slightly bending position, then push up this button to fix and lock the fiber.

10, close the clip to fix the cable and screw up the boot, put on the house.







11, re-use.

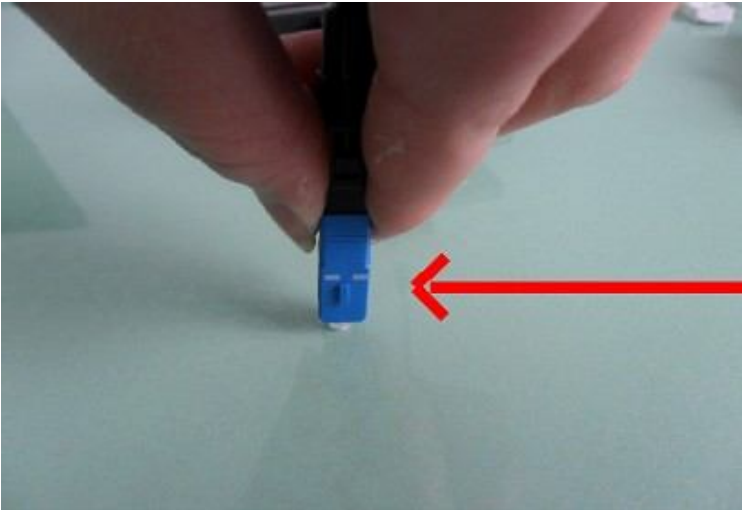

Move out the house.

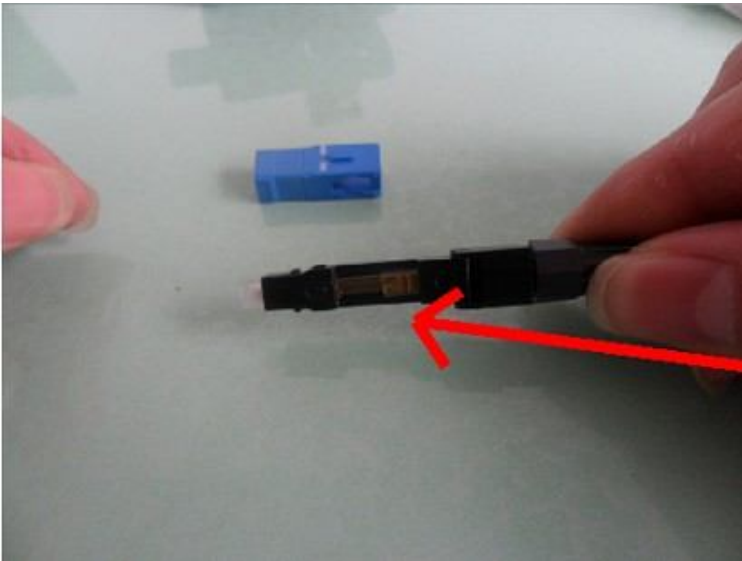

Push down this button and pull out the fiber and repeat installation steps.